

Sensor Sensitivity Solution



Sensor in Bracket



Sensor Remove from Bracket

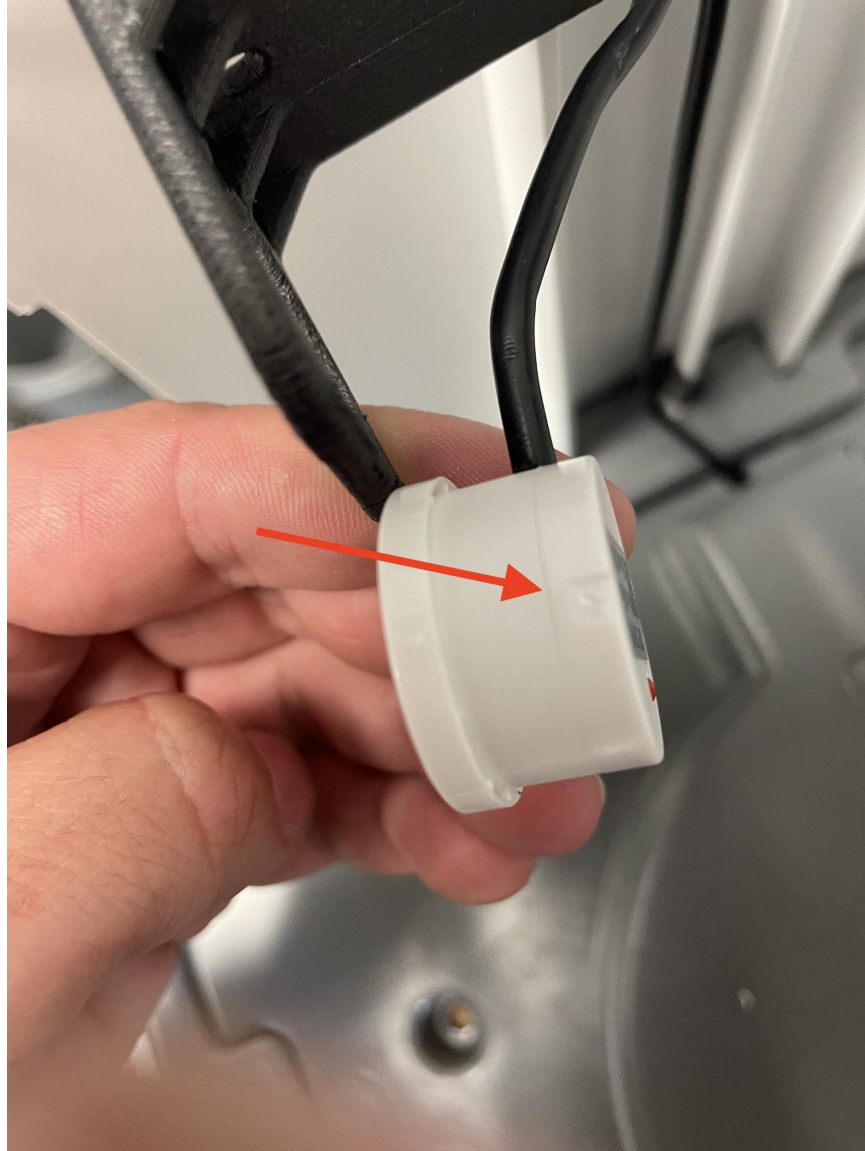

Sensor Back Line



Sensor Back Remove with Screwdriver

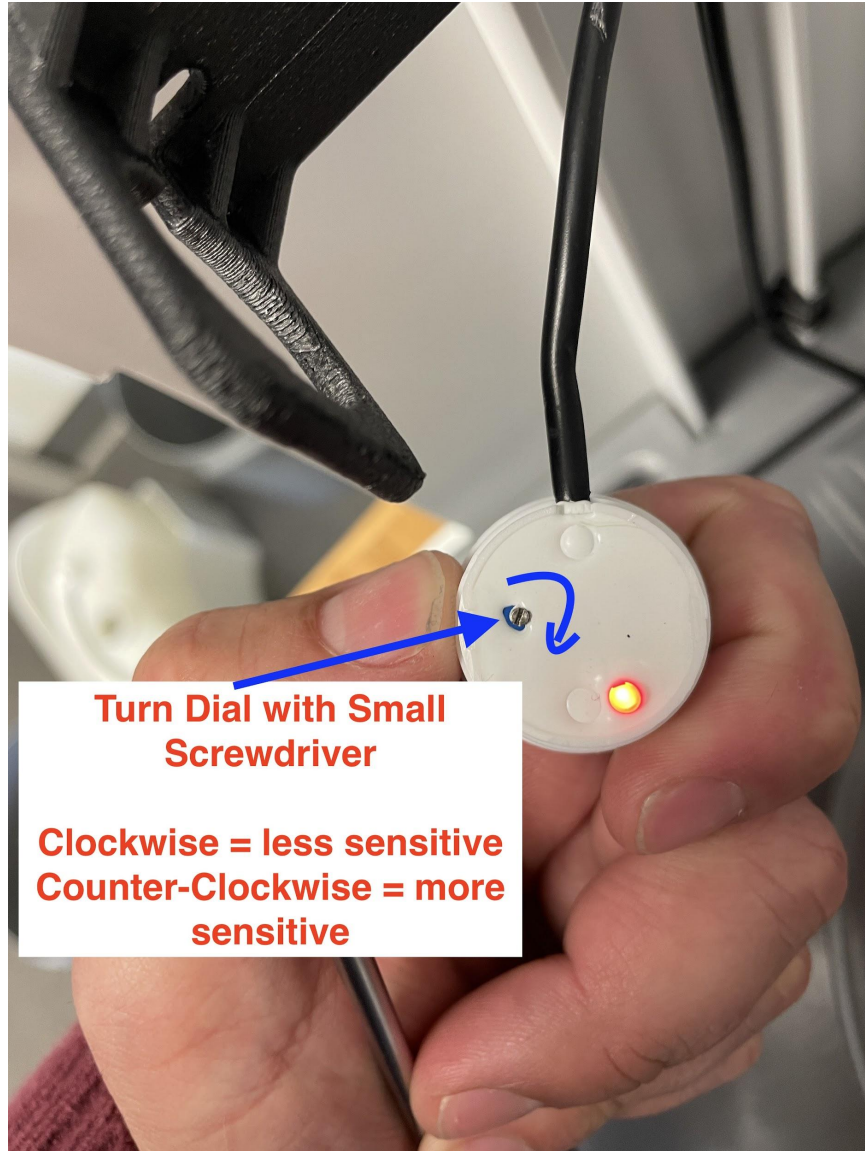

Sensor Fix. Turn Clockwise in this orientation to make the sensor less sensitive.

We suggest a 180 degree turn and then test if it works.

The sensor **should not** be triggered when the bottle and drawer are closed and the bottle is **empty**.

It **should** trigger when the bottle and drawer are closed and the bottle is **full**.